

304 STAINLESS STEEL CONSTRUCTION

[www.reytek.com](http://www.reytek.com)

16ga SHELVES  
2" SQ TUBING FRAME

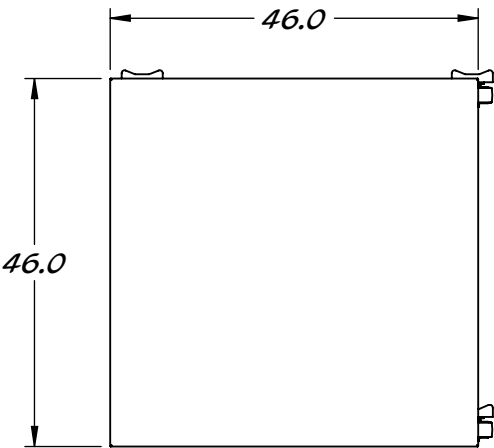

4x SS LOCKING SWIVEL  
CASTERS, HIGH CAPACITY,  
POLYURETHANE TREAD

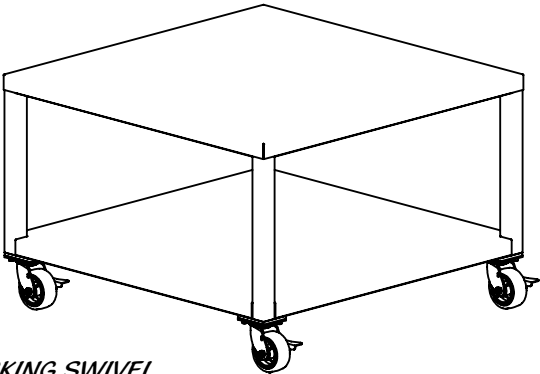

2 SUPPORT MEMBERS UNDER TOP  
1 MEMBER UNDER BOTTOM

